

QUESTION 1

Shall the Wittenberg-Birnamwood School District, Shawano and Marathon Counties, Wisconsin be authorized to issue pursuant to Chapter 67 of the Wisconsin Statutes, general obligation bonds in an amount not to exceed \$13,105,000 for the public purpose of paying the cost of a District-wide school building and improvement program consisting of: safety and security improvements, including secure entrances, upgrades to labs, technical education and other classroom areas, remodeling and building infrastructure improvements at all District facilities; construction of an agricultural and maintenance facility at the High School; construction of classroom additions at the Elementary & Middle Schools; and acquisition of furnishings, fixtures and equipment?

QUESTION 2

Shall the Wittenberg-Birnamwood School District, Shawano and Marathon Counties, Wisconsin be authorized to issue pursuant to Chapter 67 of the Wisconsin Statutes, general obligation bonds in an amount not to exceed \$4,420,000 for the public purpose of paying the cost of constructing and equipping a new gymnasium at the High School?



2018 REFERENDUM INFORMATION

Project Budgets

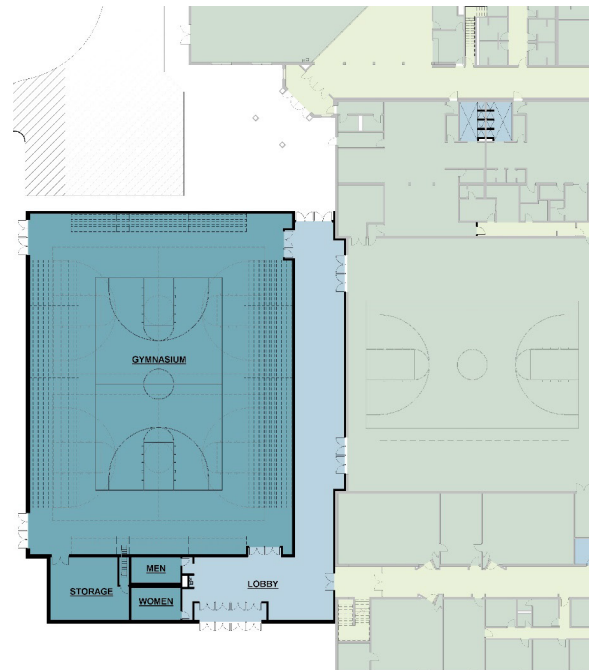
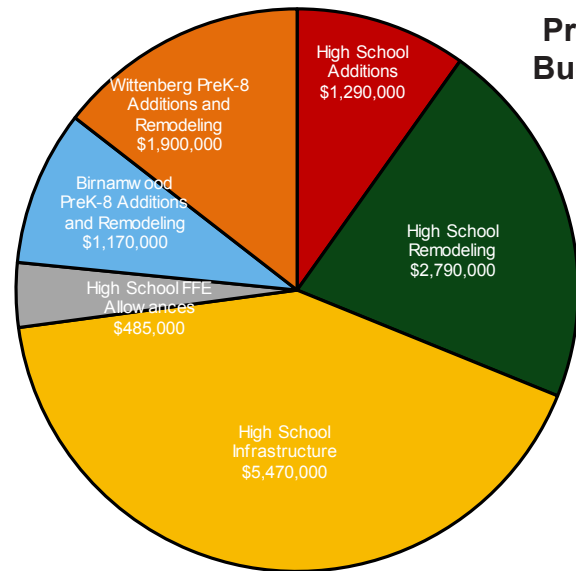

New Gymnasium Addition



The Wittenberg-Birnamwood School District is asking our community two important referenda questions concerning the future of our school buildings on Tuesday, November 6th, 2018.

THE NEEDS ARE REAL

- The newest building in the district is the high school at nearly 50 years old
- The district has committed to an average of \$318,000 each year for the last 5 years on facility improvements and needs
- Programming and safety needs at both PK-8 schools require classroom additions and vestibule changes that cannot be met out of budget
- The high school career and technical education spaces are outdated and inefficient in meeting industry standard requirements. Current infrastructure and HVAC systems do not support adequate learning environments
- Current physical education spaces are utilized over capacity throughout the year

WE HAVE BEEN RESPONSIBLE

- District's cash reserve has grown to 27% of our expenditures
- District no longer needs to short-term borrow resulting in interest costs savings of approximately \$100,000
- District has held the line on expenses – current expenses are almost the same as ten years ago
- The district established a Fund 46 Capital Projects Fund which allows us to address building maintenance projects annually without seeking taxpayer support

What impact will the referendum have on my property taxes?

Referendum Question	Borrowing Amount	Average Mill Rate Impact per \$1,000 Valuation	Daily Tax Impact on \$100,000 Property	Annual Tax Impact on \$100,000 Property
1	\$13,105,000	\$1.39	38¢	\$139
2	\$4,420,000	\$0.45	12¢	\$45

VOTE NOVEMBER 6TH

Find More Information at
www.wittbirn.k12.wi.us

Find More Information at
www.wittbirn.k12.wi.us

WE CAN IMPROVE

Birnamwood PreK-8th School

- \$1,170,000
- Remodel
 - Entry and office to provide secure & controlled access to the school.
 - Create a new accessible family restroom.
- Construct New
 - Exterior ramp at the main entrance to provide accessible entry to all students and visitors.
 - Two classroom addition to provide right-sized classrooms and accommodations for kindergarten students.

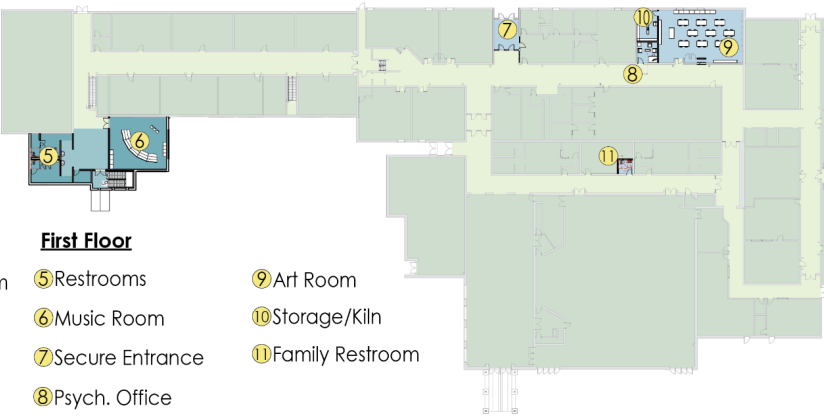
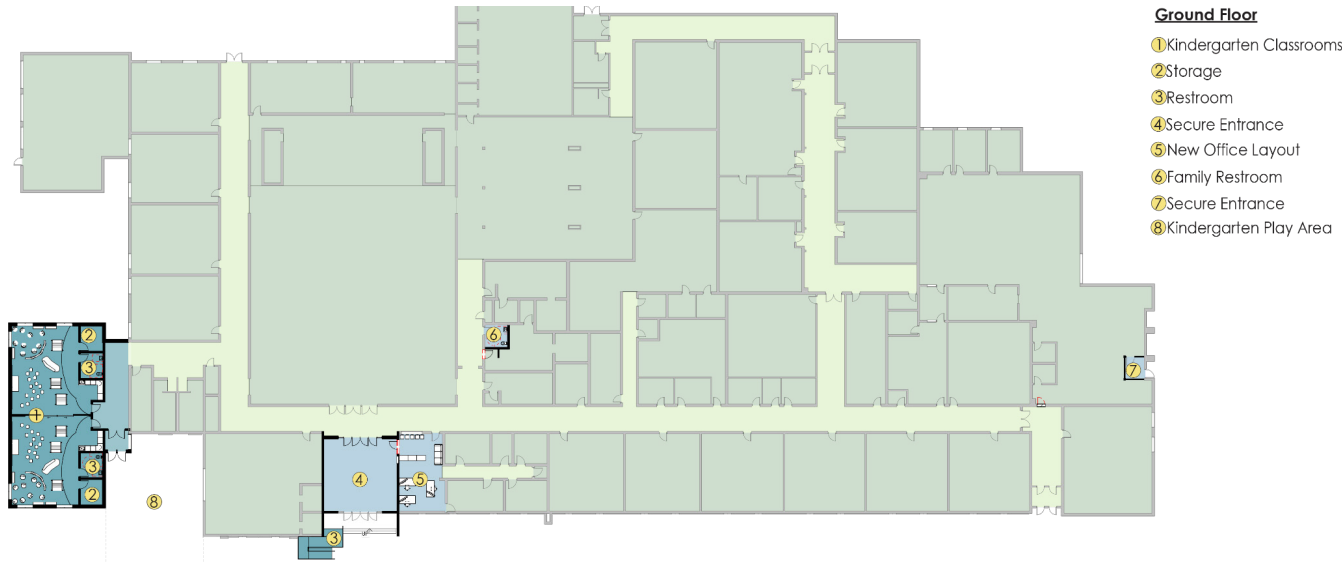

Wittenberg PreK-8th School

- \$1,900,000
- Remodel
 - Entry and office to provide secure & controlled access to the school.
 - Create a new accessible family restroom.
 - Create new art room, kiln room, and psychology office.
 - Kindergarten and PreK spaces to provide right-sized classrooms and accommodations for students.
- Construct New
 - Three classroom addition
 - New accessible toilet rooms serving the north wing of the first floor.

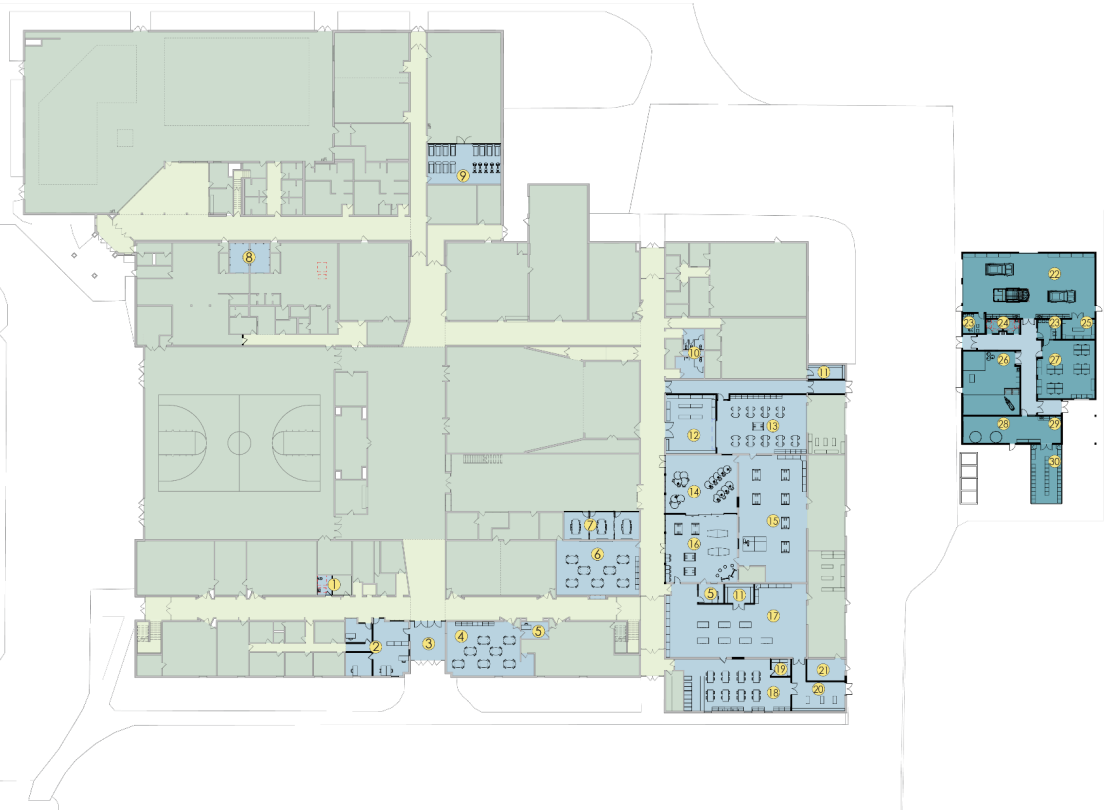

High School

- Remodel – \$2,790,000
 - Entry and office to provide secure & controlled access to the school.
 - Technology education area to address modern career training, STEM education, and interdisciplinary project collaboration.
 - Library to create collaboration spaces.
 - Repurpose existing agricultural classroom to expand technology and STEM education as well as provide space for theater storage and theater prop building.
 - Science classrooms to upgrade infrastructure and finishes.
 - Locker room showers to address function.
 - Fitness center to create separate cardio and strength training areas.
 - Infrastructure / building systems and lighting.
- Construct New - \$1,290,000
 - Agricultural education building including an “animal lab”, classroom, toilet rooms, storage, and a greenhouse.
 - Maintenance garage as part of agricultural education building.
- \$485,000 in Allowances – Includes hazardous materials abatement, furniture, equipment, etc
- Second Question - \$4,420,000
 - New 2 Station Gymnasium

